



MODEL KYMCO AK550

YEAR 2017 -->

LINE FULL SYSTEM

MUFFLER SPEED EDGE

SCHEMATIC

ELENCO PARTI / PARTS LIST

| # | QTÀ / QTY | DESCRIZIONE / DESCRIPTION | CODICE / CODE |
|----|-----------|---|----------------|
| 1 | 1 | Vite M5 x 8 / Screw M5 x 8 | 50.73.459.1 |
| 2 | 1 | DB killer / DB killer | 50.DK.090.0 |
| 3 | 1 | Tappo in gomma / Rubber stopper | 50.73.266.1 |
| 4 | 1 | Silenziatore / Muffler | SPEED EDGE 350 |
| 5 | 2 | Rondella di sicurezza / Safety washer | 50.73.604.1 |
| 6 | 2 | Vite M8 x 16 / Screw M8 x 16 | 50.73.098.1 |
| 7 | 1 | Staffa / Bracket | 50.SS.1000.0 |
| 8 | 2 | Dado M10 flangiato / Flanged nut M10 | 50.73.332.1 |
| 9 | 2 | Rondella in gomma / Rubber washer | 50.73.227.1 |
| 10 | 2 | Rondella in alluminio nera / Black aluminium washer | 50.73.330.1 |
| 11 | 2 | Vite M10x45 / Screw M10x45 | 50.73.888.1 |
| 12 | 4 | Molla media / Middle spring | 50.73.359.1 |
| 13 | 4 | Tubo in gomma per molla / Rubber pipe for spring | 50.73.210.1 |
| 14 | 4 | Dado M8 flangiato / Flanged nut M8 | 50.73.393.1 |
| 15 | 1 | Collettore #1 / Down pipe #1 | 9773O009SEA |
| 16 | 1 | Collettore #2 / Down pipe #2 | 9773O009SEB |
| 17 | 1 | Tubo di raccordo / Link pipe | 9773O009SEC |
| 18 | 1 | Tubo di raccordo / Link pipe | 9773O009SED |
| 19 | 2 | Distanziale in alluminio / Aluminium spacer | 50.SS.108.1 |

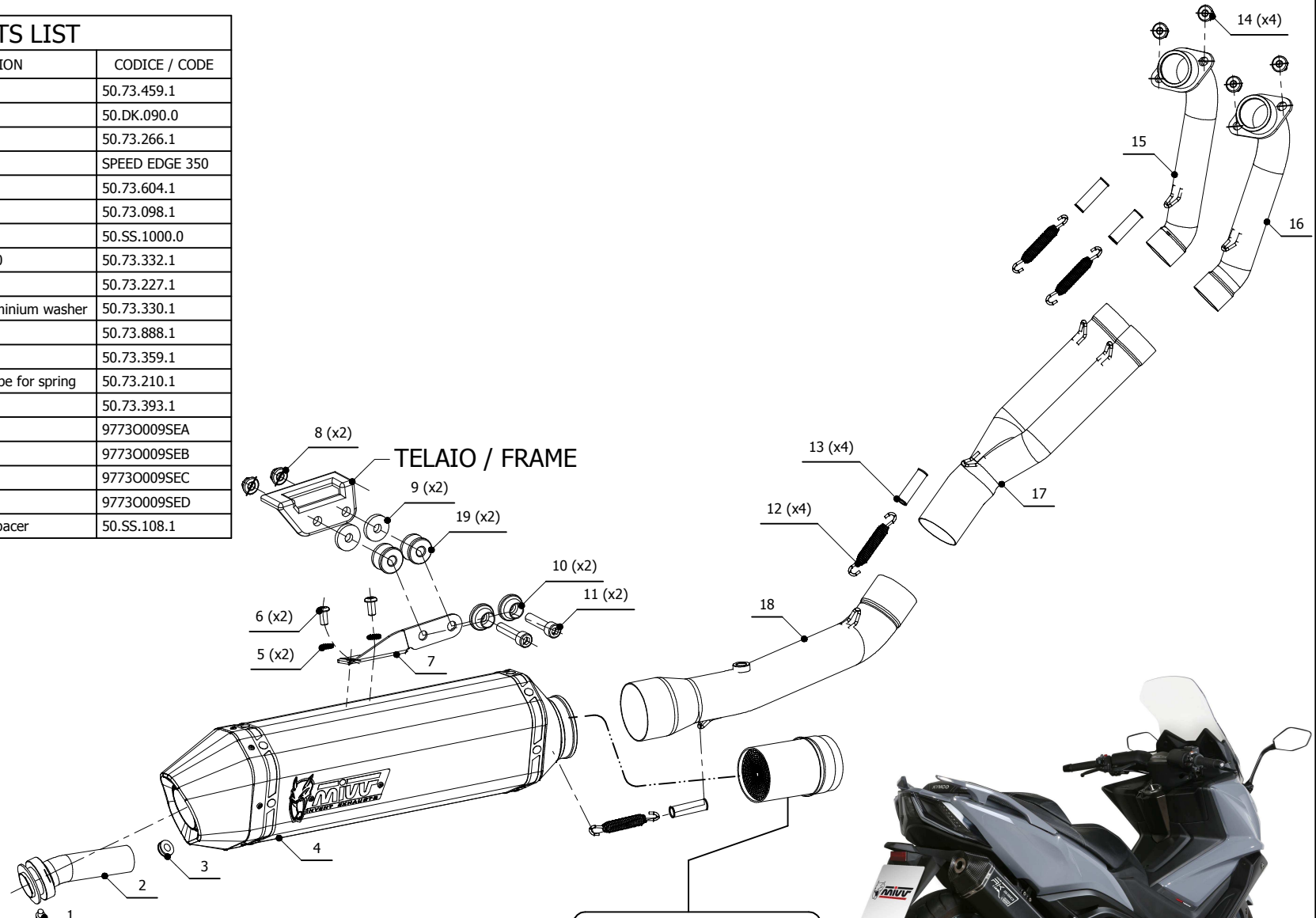

TELAIO / FRAME

Catalytic Converter
Cod. ACC.045.A1
Optional for O.009.LRX-O.009.LRB
Included in O.009.KRX-O.009.KRB



APPLICAZIONI / APPLICATIONS

| CODICE / CODE | SILENZIATORE / MUFFLER | LOGO | TUBO / PIPE | NOTE |
|------------------------|--|--------------------------|------------------|-------------------------------------|
| O.009.LRX O.009.LRB | INOX (COPPE CARBONIO) / ST. STEEL (CARBON CAPS) STEEL BLACK | ALUMINIUM LABEL LASER | INOX / ST. STEEL | CATALYTIC CONVERTER NOT INCLUDED |
| O.009.KRX O.009.KRB | INOX (COPPE CARBONIO) / ST. STEEL (CARBON CAPS) STEEL BLACK | ALUMINIUM LABEL LASER | INOX / ST. STEEL | CATALYTIC CONVERTER INCLUDED |