

SHAD

YAMAHA MT 09 - SP '21 TOP MASTER Y0MT91ST

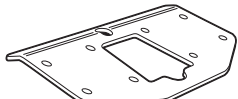

1 262761 x1



2 303045 x16
Ø8

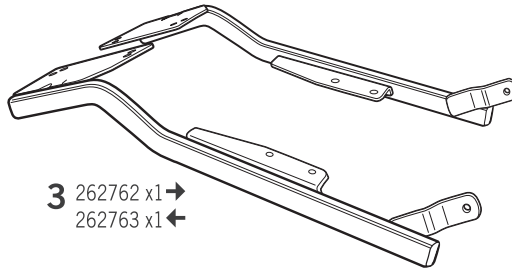

3 262762 x1 →
262763 x1 ←



4 304053 x6
M8 x 30 Din 7380



5 302024 x 4
M8

! WARNING!

GB

Do not fully tighten the screws until it is ensured that the KIT is correctly attached and aligned.

E

No apretar los tornillos del todo hasta asegurarse que el KIT está correctamente colocado y alineado.

D

Ziehen Sie die Schrauben nicht ganz fest, bevor Sie sich nicht vergewissert haben, daß der Bausatz korrekt eingestellt und ausgerichtet ist.

I

Non stringere del tutto le viti fin tanto non si è sicuri che il kit è collocato correttamente e allineato.

F

Ne pas serrer les vis avant d'être sûr que le KIT soit correctement positionné et ajusté.

ATTENTION: For a full equip assembly, mount the side bag holder and 3P system after the top master.

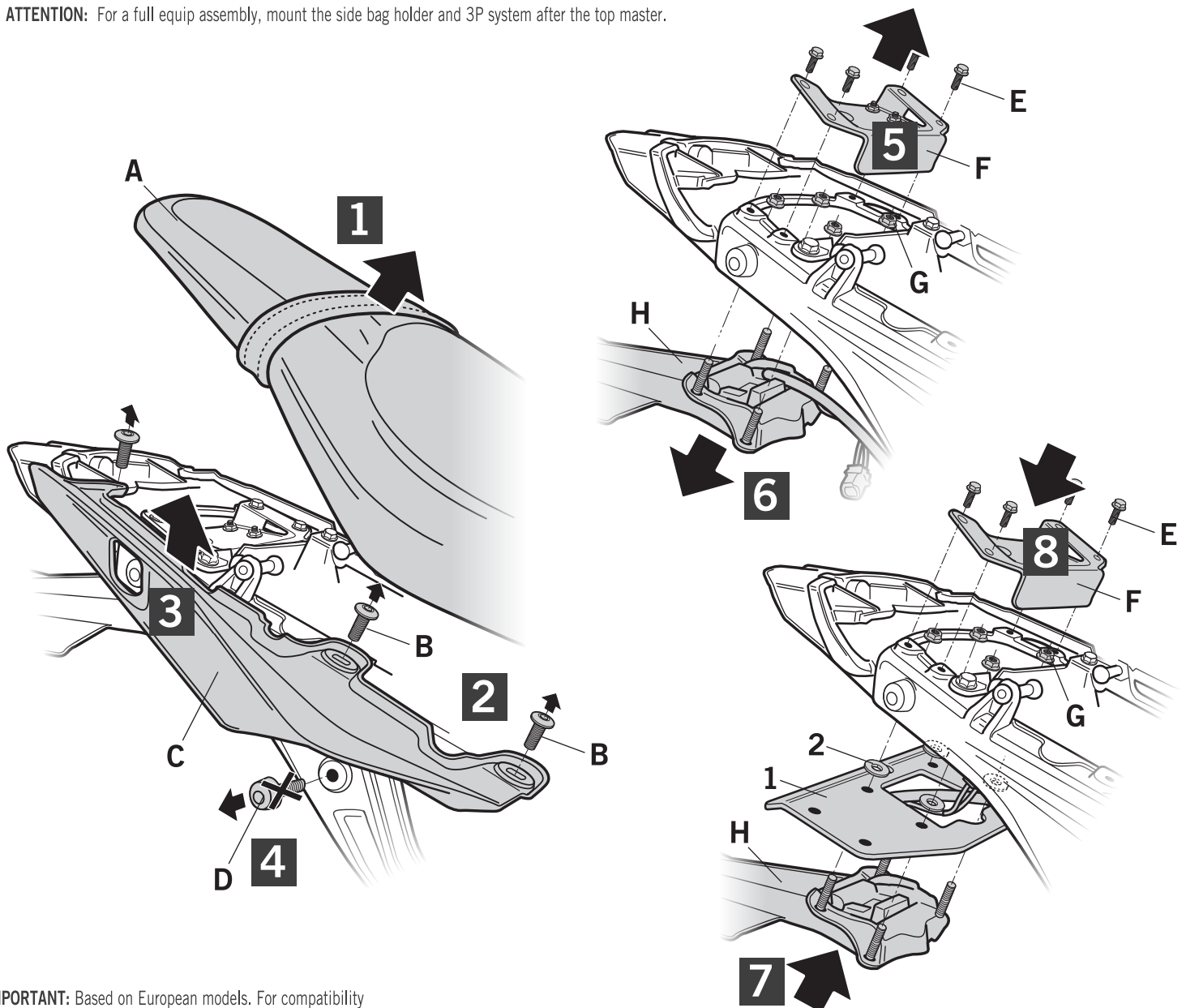

IMPORTANT: Based on European models. For compatibility with models in other continents, check www.shad.es

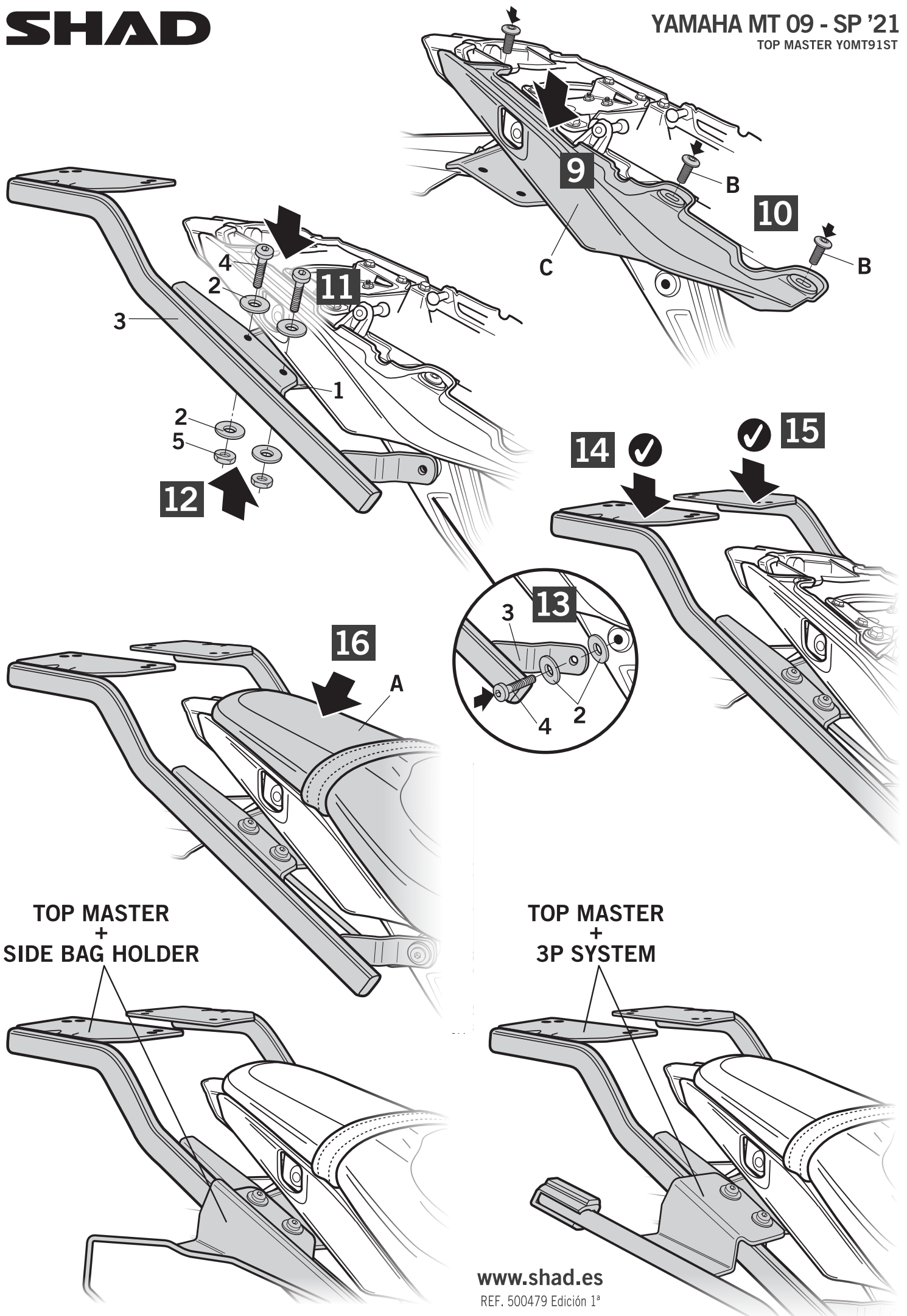

TOP MASTER
+
SIDE BAG HOLDER

TOP MASTER
+
3P SYSTEM